



**City of New York**  
**Board of Standards and Appeals**  
 40 Rector Street, 9<sup>th</sup> Floor  
 New York, NY 10006-1705  
 Phone: (212) 788-8500  
 Fax: (212) 788-8769

**ZONING (BZ) CALENDAR**

*Application Form*

188-07-BZ  
 BSA APPLICATION NO. 08 BSA 009M  
 CEOR

**Section A**

*Applicant/  
Owner*

<b>Friedman &amp; Gotbaum, LLP</b>	<b>Hilton Hotels Corporation</b>
<i>NAME OF APPLICANT</i>	<i>OWNER OF RECORD</i>
568 Broadway, Suite 505	9336 Civic Center Drive
<i>ADDRESS</i>	<i>ADDRESS</i>
New York NY 10012	Beverly Hills CA 90403
<i>CITY STATE ZIP</i>	<i>CITY STATE ZIP</i>
212 925 4545	Spa Chakra, LLC
<i>AREA CODE TELEPHONE</i>	<i>LESSEE / CONTRACT VENDEE</i>
212 925 5199	730 Fifth Avenue
<i>AREA CODE FAX</i>	<i>ADDRESS</i>
lcuisinier@frigot.com	New York NY 10019
<i>EMAIL</i>	<i>CITY STATE ZIP</i>

**Section B**

*Site  
Data*

*All sections  
must be  
completed*

**Waldorf=Astoria, 301 Park Avenue, New York, NY**  
*STREET ADDRESS (INCLUDE ANY A/K/A)*

Entire block bounded by Park & Lexington avenues and East 49th & 50th streets  
*DESCRIPTION OF PROPERTY BY BOUNDING OR CROSS STREETS*

1304	1	Manhattan	CB 5	No. 63684
<i>BLOCK</i>	<i>LOT(S)</i>	<i>BOROUGH</i>	<i>COMMUNITY DISTRICT NO.</i>	<i>CERTIFICATE OF OCCUPANCY NO.</i>
C5-2.5/C5-3/C6-6	8d	Daniel R. Garodnick		
<i>EXISTING ZONING DISTRICT</i>	<i>ZONING MAP NUMBER</i>	<i>CITY COUNCILMEMBER</i>		

*(include special zoning district, if any)*

**Section C**  
*Department  
Of Buildings  
Decision*

BSA AUTHORIZING SECTION(S): 73-03; 73-36 FOR:  VARIANCE  SPECIAL PERMIT (Including 11-41)

SECTION(S) OF ZONING RESOLUTION SOUGHT TO BE VARIED: 32-31(uses by special permit by BSA)

DOB DECISION (OBJECTION / DENIAL) DATED: 07/27/07 ACTING ON APPLICATION NO: 104818164

**Section D**

*Description*

(LEGALIZATION  YES  NO  IN PART)

Applicant seeks special permit pursuant to ZR Sec. 73-01 & 73-36 to allow a Physical Culture Establishment in a portion of an existing building (19th floor & p/o lobby level) in a C5-2.5/C5-3/C6-6 zoning district.

**Section E**  
*BSA History  
and  
Related  
Actions*

If "YES" to any of the below questions, please explain in the STATEMENT OF FACTS

Has the premises been the subject of any previous BSA application(s)?.....	YES <input checked="" type="checkbox"/>	NO <input type="checkbox"/>
PRIOR BSA APPLICATION NO(S): <u>Cal. No. 561-65-BZ; 562-65-A</u>		
Are there any applications concerning the premises pending before any other government agency?	<input type="checkbox"/>	<input checked="" type="checkbox"/>
Is the premises the subject of any court action?.....	<input type="checkbox"/>	<input checked="" type="checkbox"/>

I HEREBY AFFIRM THAT BASED ON INFORMATION AND BELIEF, THE ABOVE STATEMENTS AND THE STATEMENTS CONTAINED IN THE PAPERS ARE TRUE

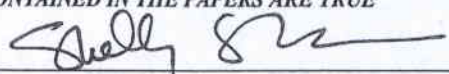
  
 Signature of Applicant, Corporate Officer or Other Authorized Representative

SWORN TO ME THIS 1st DAY OF August 2007

**Shelly S. Friedman** Counsel  
 Print Name Title

  
 NOTARY PUBLIC

**ELENA ARISTOVA**  
 NOTARY PUBLIC, State of New York  
 No. 01AR6050323  
 Qualified in Kings County  
 Commission Expires November 6, 2010

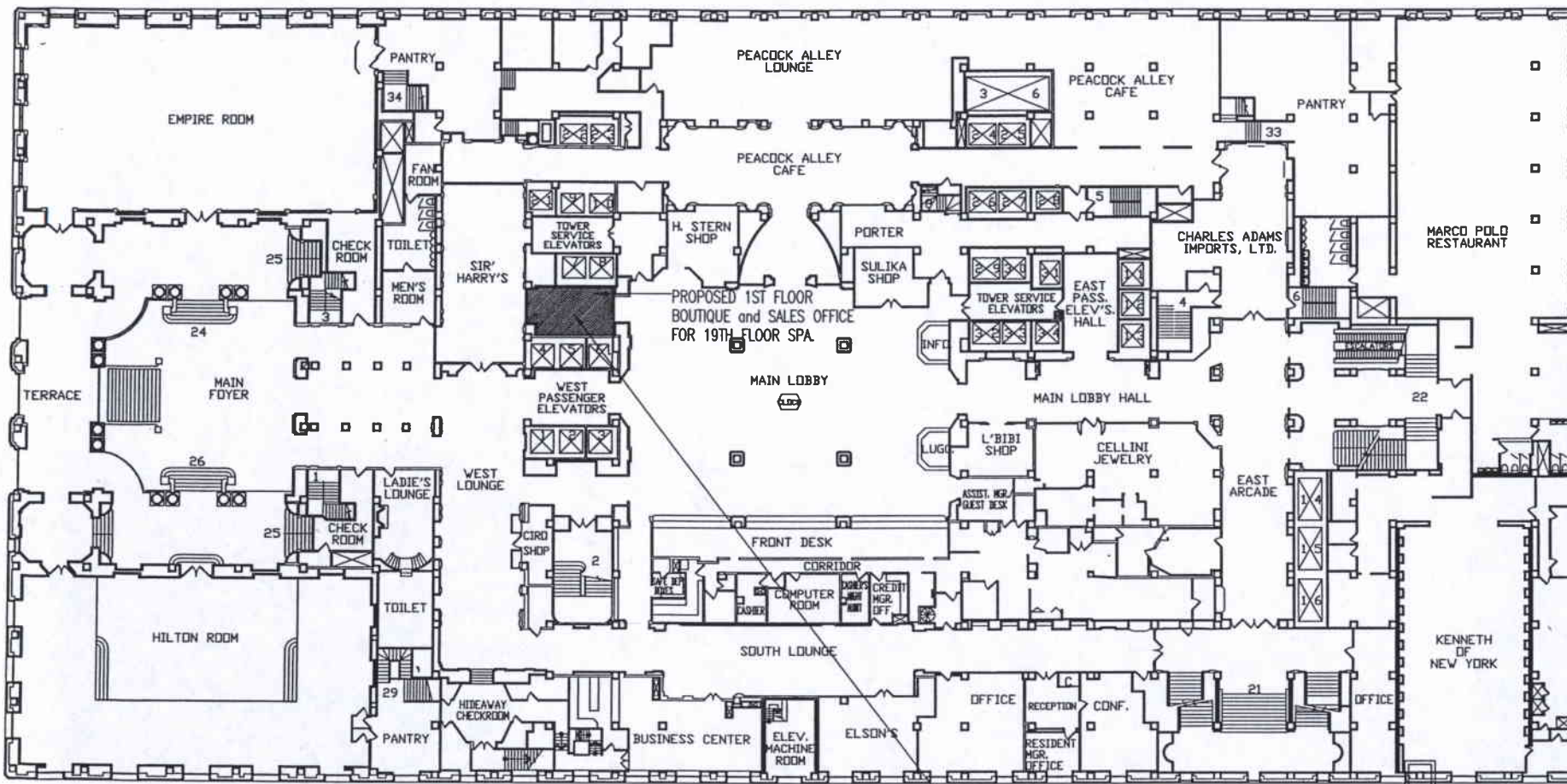

**1- 1ST FLOOR PROPOSED PCE BOUTIQUE/SALES OFFICE**  
(19th FLOOR SPA)



■ PROPOSED 1ST FLOOR BOUTIQUE and SALES OFFICE FOR 19TH FLOOR SPA.



NOTE: THE PCE SPACE AT THE FIRST FLOOR IS THE FIRST FLOOR BOUTIQUE. THE USABLE SQ.FT. IS 960 SQ.FT.



**NOTE:**

1. ALL PARTITIONS AND EXITS SHALL BE AS SHOWN.
2. MINIMUM 3'-0" WIDE EXIT PATHS SHALL BE MAINTAINED THROUGHOUT THE ENTIRE PCE SPACE, INCLUDING FROM ANY GYMNASIUM.
3. AN APPROVED INTERIOR FIRE ALARM SYSTEM SHALL BE INSTALLED THROUGHOUT THE ENTIRE PCE SPACE, THE SYSTEM SHALL INCLUDE:
  - AREA SMOKE DETECTORS
  - MANUAL PULL STATIONS @ EACH EXIT
  - LOCAL AUDIBLE and VISUAL ALARM
  - CONNECTION OF THE INTERIOR SYSTEM TO THE BOARD BASED APPROVED CENTRAL STATION.
4. LOCAL LAW 58 and 87 SHALL APPLY.

DATE	REVISIONS	DRAWING TITLE	PROJECT #
5-23-07	REVISED	1ST FLOOR PROPOSED BOUTIQUE/SALES OFFICE	5143
			DATE: 6-11-07
			SCALE: 1/32"=1'-0"
			DWG # T-004